

**ARCON**  
**ARUN ASHOK**

**MANSION**

**ARCON**

**ARCON PROJECT PVT. LTD.**  
AN ISO 9001:2008 CERTIFIED COMPANY



Opposite Danapur Block office, Danapur

*Residential cum commercial place*

RERA NO. : BRERAP30301-2/107/R-1435/2022





**ARCON**  
**ARUN ASHOK**  
**MANSION**

Opposite Danapur Block office, Danapur

*A realization of  
your dreams begins now*



Luxurious Living



Commercial Space



Peaceful Environs



Safety & Security

Welcome to ARCON ARUN ASHOK MANSION, Opposite Danapur Block office, Danapur, your apartment home umid unparalleled luxuries and lush green settings at roof top. and commercial complex at Ground, 1st and 2nd floor.

At ARCON ARUN ASHOK MANSION you get the best of both worlds, unmistakably natural and luxuriously urban.



# Luxurious living

At ARCON ARUN ASHOK MANSION, the lifestyle of luxuries begins, the moment you step in every single corner echoes the themes of unprecedented privileges and rewrites the rules by reinventing elegance.

The impact is a stunning medley of space optimization and aesthetic expressions. In fact, the interiors are shaped to shape your lifestyle with select keynotes of splendor and grandeur.

ARCON ARUN ASHOK MANSION are an answer to the urge of urbanites for seclusion, privacy and independence in hand with the luxuries and comforts. the meticulously crafted apartments create magic within walls.

The amalgamation of color, design style and comfort diffuses sensual warmth. The positivity of ambience would lend vitality to life and is perfect to nurture relationship.



- Optimum space utilisation
- Well Ventilated living rooms
- Sizeable modular kitchens
- Generous bedrooms with attached bathroom
- Superior fittings in all rooms
- vastu friendly layouts in commercial & residential



---

## ATTRACTION OF THE PROJECT

- Residential and commercial project
- Every flat fully lighted and airy
- Near Police station & Railway station
- Near Danapur Civil Court
- Opposite of Danapur Block office
- Nearest to best 7 school of Patna
- best Nursing homes nearer to the project





Typical Floor Plan of 3rd, 4th & 5th Floor

**FLAT NO. : 01**  
**S/B UP AREA : 1837.0 SQFT.**  
 3 Bedrooms 2 Toilets  
 2 Balconies  
 1 Servant Room

**FLAT NO. : 02**  
**S/B UP AREA : 1837.0 SQFT.**  
 3 Bedrooms 2 Toilets  
 2 Balconies  
 1 Servant Room

**FLAT NO. : 03**  
**S/B UP AREA : 1560.0 SQFT.**  
 3 Bedrooms 2 Toilets  
 1 Balcony  
 1 Servant Room

**FLAT NO. : 04**  
**S/B UP AREA : 1855.0 SQFT.**  
 3 Bedrooms 2 Toilets  
 2 Balconies  
 1 Servant Room



**3** Floor for residential  
**12** Residential flats of 3 BHK

ARCON ARUN ASHOK MANSION is strategically located in one of the best residential location area of Patna with easy access to educational institutions , shopping malls, hospitals and important business and leisure hubs. The location is ideal for cutting down your commute time while enjoying a pleasantly relaxed lifestyle and nature splendors. The Project located at Opposite Danapur Block office, Danapur.



*Flat type*  
**3BHK**

**S/B UP AREA : 1837.0 SQFT.**

 3 Bedrooms  2 Toilets

 2 Balconies

 1 Servant Room



**S/B UP AREA : 1560.0 SQFT.**

*Flat type*  
**3BHK**

 3 Bedrooms  2 Toilets

 1 Balcony

 1 Servant Room

# Basement Plan

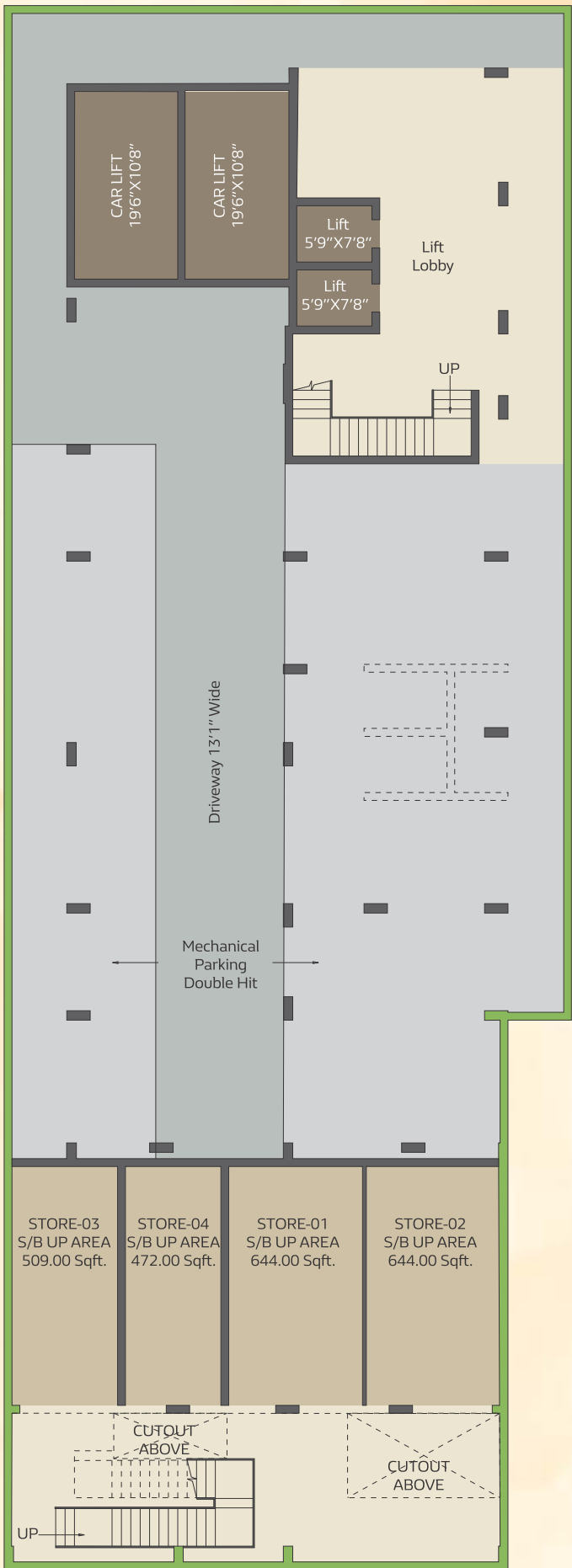

# Terrace Plan





Ground Floor Plan

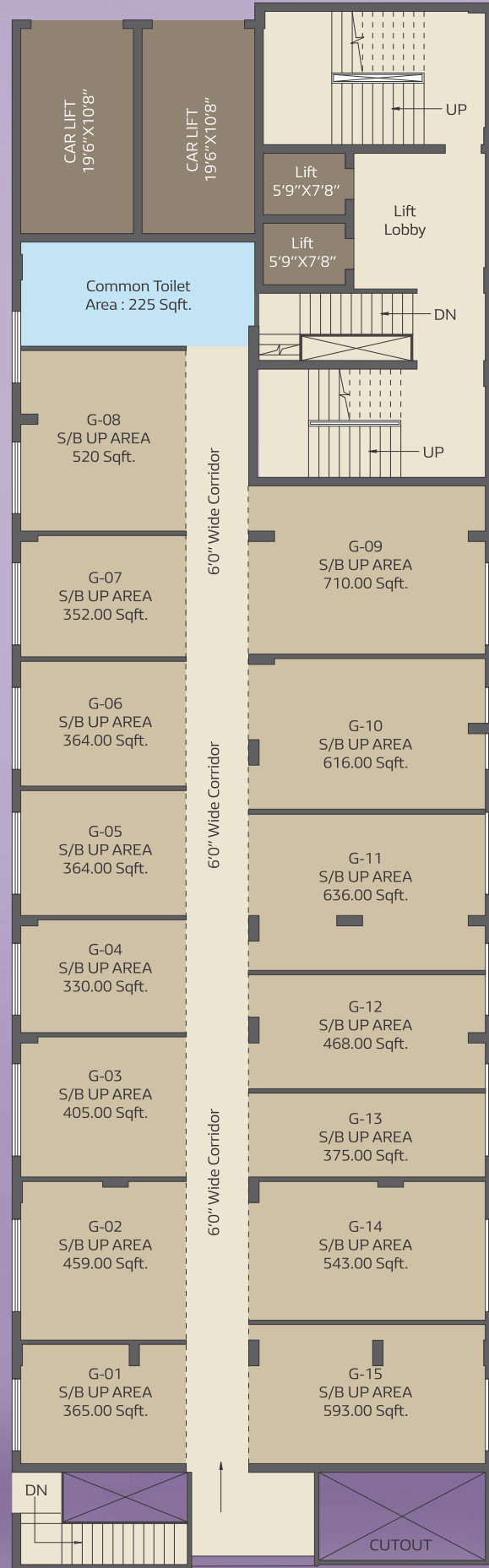

First Floor Plan

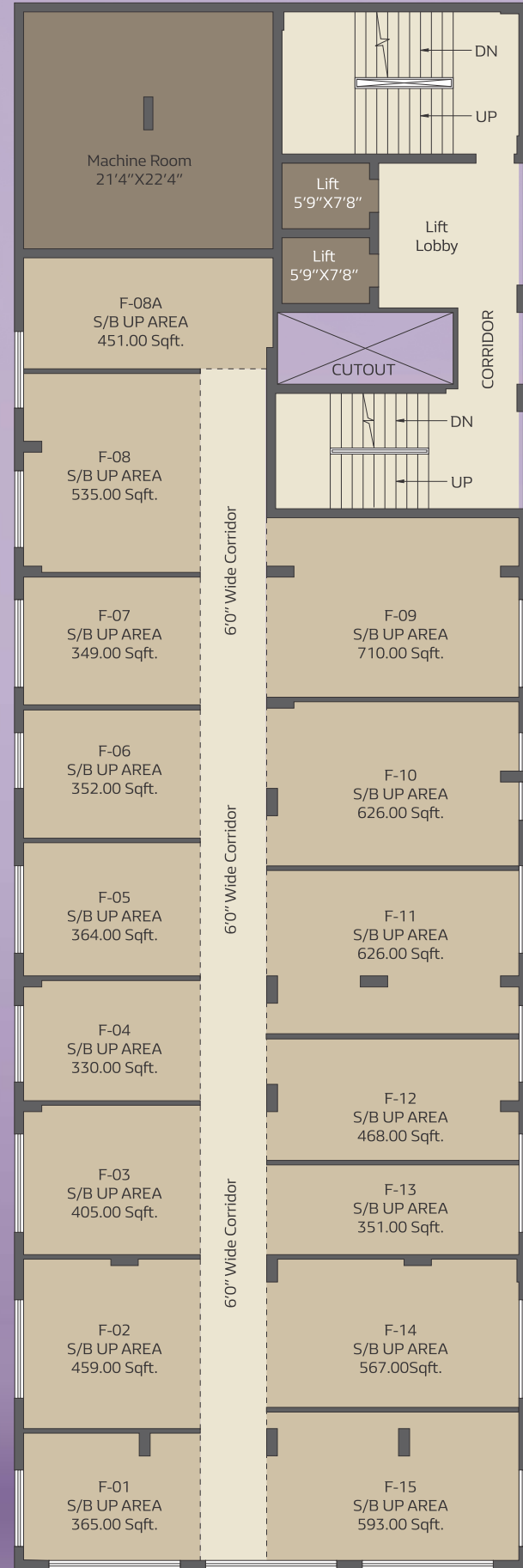

Second Floor Plan

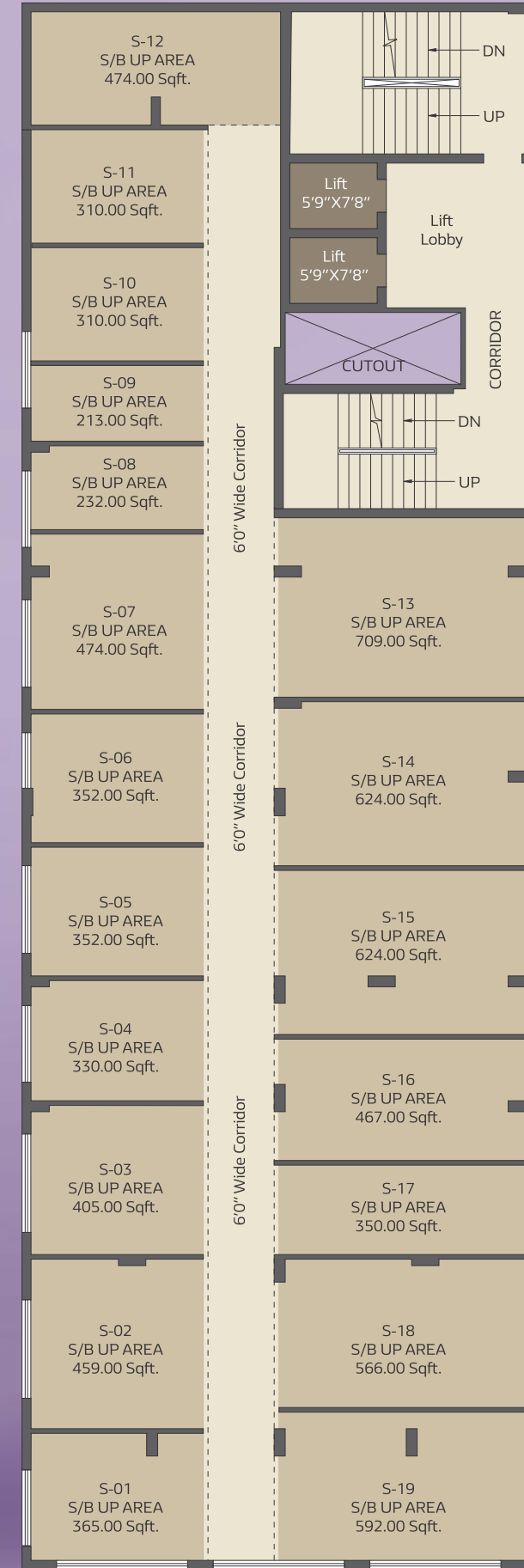

**3** Floor for commercial  
**49** Shop & Office space  
**4** Store in Basement

ARCON ARUN ASHOK MANSION Shop and office will become the benchmark in the city, offering a premium shops & office space with a variety of the most coveted shop brands space options. Retail shops with a residential space will make the premier destination of Danapur Patna.

- Inspirational shop spaces
- Modern and elegant elevation
- Wide parking area
- Full power backup
- Fire fighting system
- 24 hrs security
- Well - appointed public toilets





# specifications



## STRUCTURE

- Earthquake resistance R.C.C. frame structure.
- CLC Blocks / Modular Red bricks for an energy efficient building.

## FLOORING

- Vitrified tiles flooring inside the flat/Shop of Standard make.
- Anti - skid floor tiles of Standard make.
- 7 height Glazed tiles in toilets of Standard make.

## PAINTING

- Distemper of Asian/Berger/Nerolac paints over wall putty surface in side the flat

## EXTERIOR

- Texture paint of Asian/Berger/Nerolac paints.
- M.S. Railing on Balcony.

## KITCHEN

- Granite slabs with stainless steel sink.
- Glazed tiles on walls upto 2ft. over counter of Standard make.

## DOOR & WINDOWS

- All balcony openings to be UPVC door & windows of standard make.
- Flush doors for all internal Doors.
- All door lock to be of Godrej/Doorset/Ozone or equivalent make.

## BATHROOMS

- Chinaware Jaguar / Hindware / Parryware / Johnson or equivalent make.
- CP fittings of Jaguar / Hindware / Parryware / Johnson or equivalent make.

## ELECTRICAL

- Electrical (Copper) Wiring as per ISI code with modular switches of Anchor or equivalent make.
- Circuits with MCB of approved make as per ISI code. TV and Telephone points in every room.
- **Additional Features :** Cupboard shutters / Modular Kitchen shall be provided in each residential unit.

